



L A N D M A R K C O L L E C T I O N

# Portfolio



## ABOUT GLEN-GERY

The Glen-Gery Landmark Collection is manufactured with the same attention to detail and craftsmanship that have defined all Glen-Gery products for over a century.

Founded in 1890, Glen-Gery Corporation is one of the nation's largest brick manufacturers and operates nine brick manufacturing facilities and one manufactured stone facility.



**San Moritz** • GLEN RIDGE



**Ashford** • GLEN RIDGE



**Allegheny** • CUT COBBLE and Lockport (Engineer) brick



**Buckingham** • GLEN RIDGE and Adrian brick



## A SOLID DESIGN STATEMENT

The strength, permanence and beauty of stone are benchmark qualities behind many architectural designs, whether contemporary or traditional; commercial, residential or institutional. Manufactured to the same standards of quality and beauty of all Glen-Gery products, our Landmark Collection is an essential ingredient in successful applications of practically limitless variety.

Its authenticity in hue and surface makes it a highly versatile selection, one that enables architects and designers to reach beyond limitations otherwise imposed by constraints of budget and material availability.

Available in a range of stunning colors and profiles, Glen-Gery's Landmark Collection is a truly comprehensive series. Its aesthetic potential is displayed in structures from coast to coast, and in the realization of designs that display the look and character of natural stone.

The lasting charm of stone imparts an aura of security and permanence that's as appropriate in educational and medical buildings as it is in first-class homes and commercial structures. The Landmark Collection extends that special appeal to the widest possible range of architectural designs.

Glen-Gery products are available from a network of over 500 distributors across the United States and Canada. Visit our website at [glengery.com](http://glengery.com) to find a distributor nearest to you.

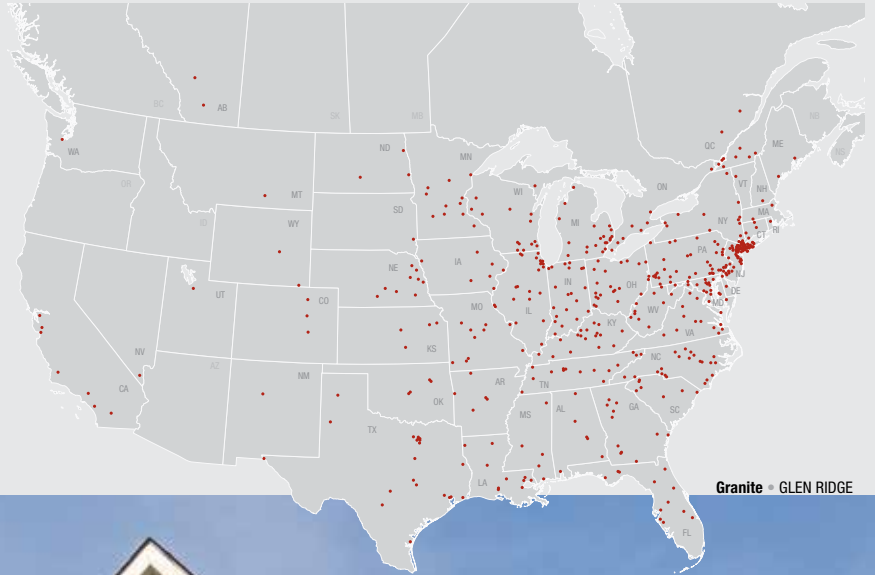

Granite • GLEN RIDGE





## KEY FEATURES

Buckingham • FIELDSTONE

- The Landmark Collection is available in dozens of versatile, visually appealing colors and profiles.
- Made with high quality materials, the Landmark Collection delivers a truly lasting architectural solution, supported by a 50-year warranty.
- The Landmark Collection meets or exceeds code requirements as verified by the Uniform Evaluation Service.
- Unlike some natural stone varieties, our manufactured Landmark Collection is always available.
- Where budgets preclude natural stone, the Landmark Collection can be the ideal choice.
- A full selection of accessories compliments and completes the design.
- Crafted to high environmental standards, can contribute to LEED Certification.







Ashford • LEDGESTONE



San Moritz • FIELDSTONE

The look and feel of natural stone.

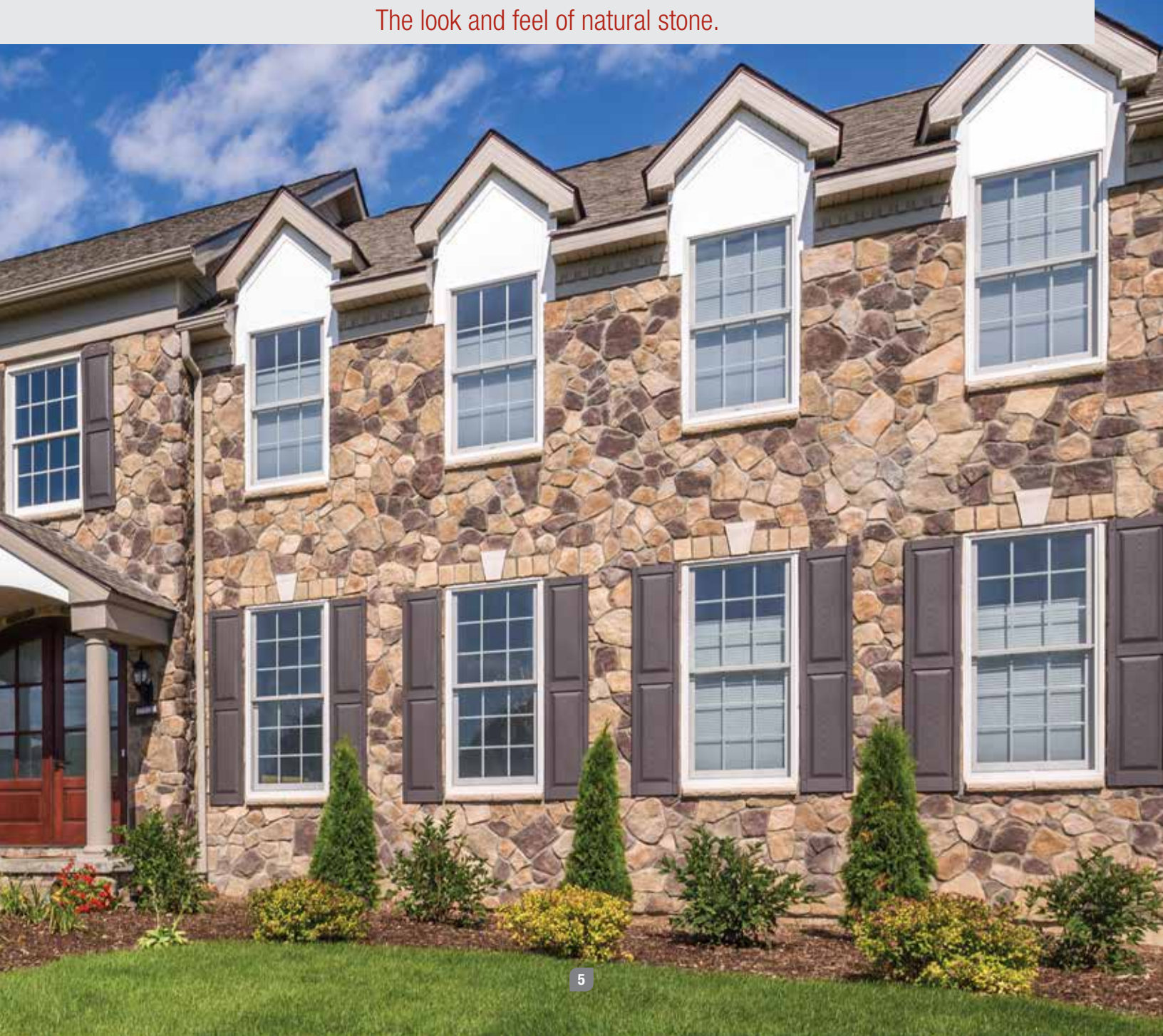



## Residential Gallery

As beautiful as it is versatile, the Landmark Collection is a preferred building material for elite residences around the country. In virtually any architectural or landscape context, the Landmark Collection

varieties offer the look ideally suited to the plan. An extraordinary range of colors, textures and forms contributes to the full realization of home designs, as these examples illustrate.



**San Moritz** • FIELDSTONE and Waterford brick



**Buckingham** • FIELDSTONE



**Kentucky Gray** • LIMESTONE







## Residential Gallery

The rich, authentic stone detail that distinguishes every variety of the Landmark Collection delivers endless creative possibilities in residential architecture. Traditional or contemporary, projecting rustic appeal or urban sophistication, the aesthetic potential of this product responds to endless designs. It's also made to harmonize ideally with other construction materials.



Ashford • LEDGESTONE without mortar

Blue Ridge • LEDGESTONE







Ashford • LEDGESTONE with mortar



Ashford • LEDGESTONE with Glen-Gery Color Mortar

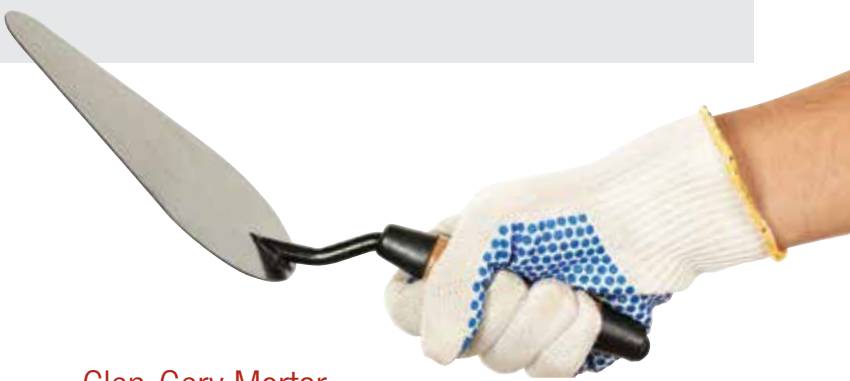

## Glen-Gery Mortar

Mortar adds tremendous versatility to the design palette. It's a beautiful alternative for Ledgestone, Stackstone and Glen Ridge profiles which are often finished without mortar. Color mortar becomes an exciting enhancement to other stone varieties that would otherwise employ traditional gray mortar.

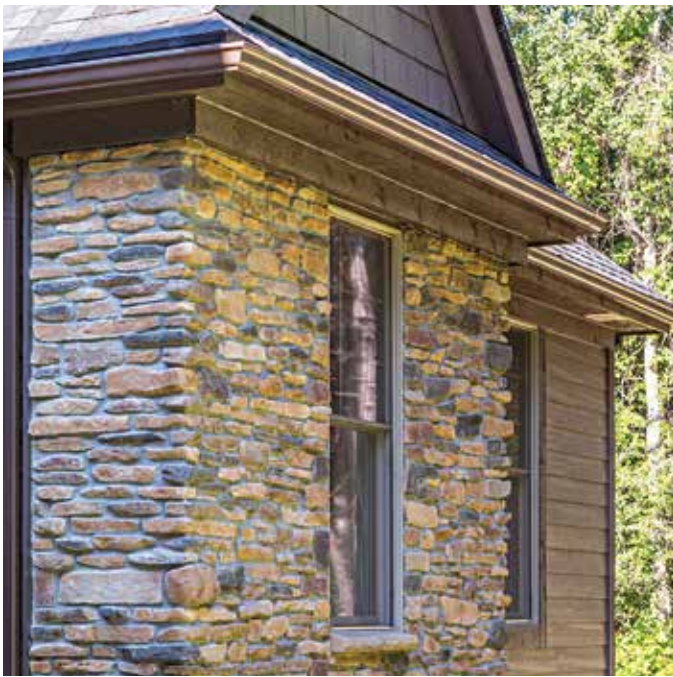

Ashford • LEDGESTONE with mortar





**Chisel Gray** • LIMESTONE



**Ashford** • LEDGESTONE and Merlot Full-Range brick



**Sonoma** • GLEN RIDGE and Merlot Full-Range brick





Harrison • LIMESTONE

## Glen-Gery Picture Perfect Visualizer

Responsive and user-friendly, Glen-Gery's Picture Perfect design tool makes it simple to visualize the use of Landmark Collection in your project. Across three easy-to-use versions, browse galleries of residential and commercial images, alter them as you like, apply Landmark to pictures of actual structures, or call on our design professionals for assistance. Begin at [www.glengery.com/visualizer](http://www.glengery.com/visualizer)

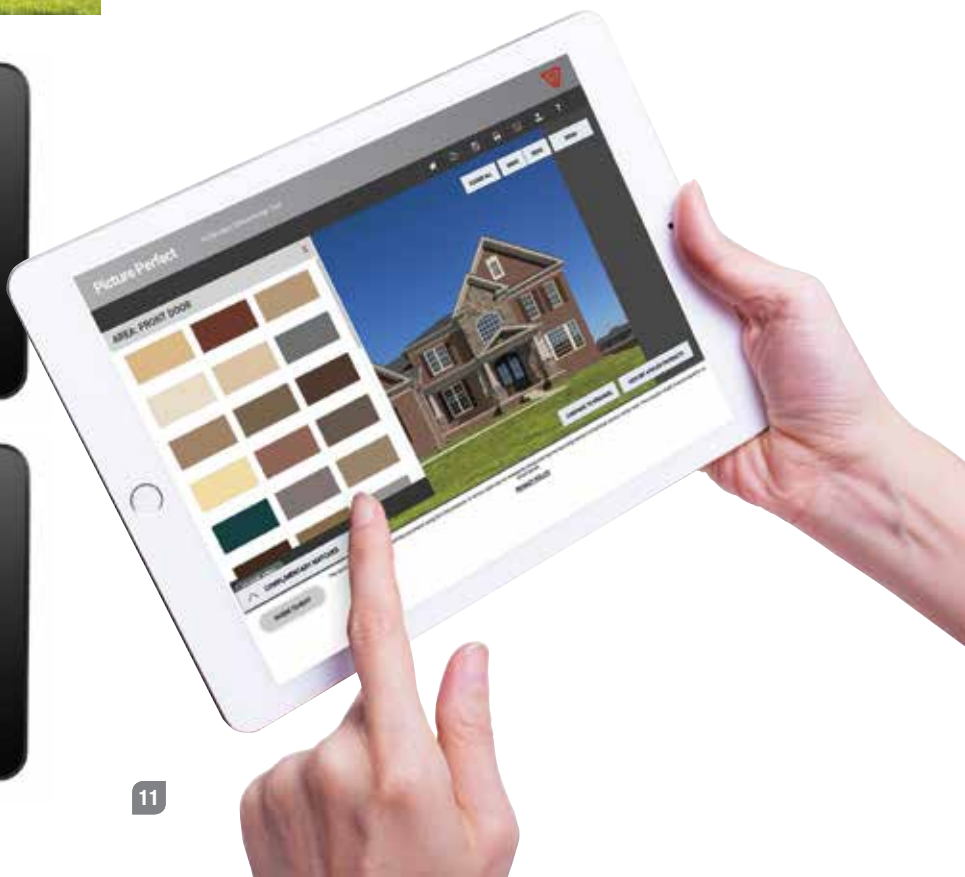



## Commercial Gallery

The exterior presentation of any business is a fundamental part of its brand. In its many incarnations, the Landmark Collection facilitates the selection and development of a look that perfectly

expresses the unique identity and character of a company. This appealing, attractive resource liberates architectural designers to find the defining essence of any business.



Allegheny • CUT COBBLE and Adrian brick



Sonoma • LEDGESTONE and Wilmette Ironspot brick

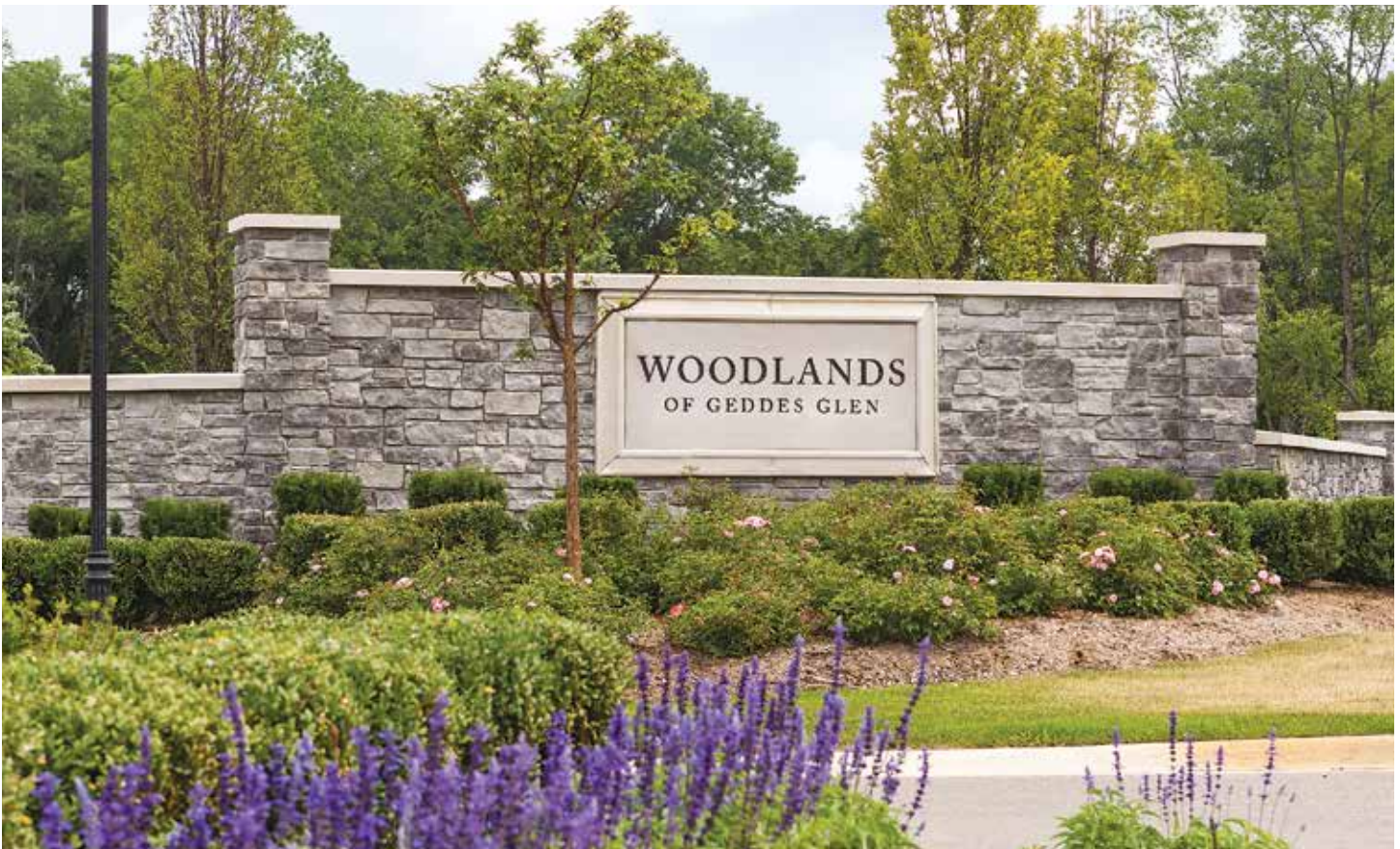

Granite • GLEN RIDGE









Ashford • STACKSTONE



Allegheny • CUT COBBLE and Adrian brick



Sonoma • LEDGESTONE





Allegheny • CUT COBBLE and Danish "1776" thin brick

## Structurally sound, environmentally friendly

Glen-Gery's Landmark Collection meets or exceeds code requirements as verified by IAPMO Evaluation Service (Report IAPMO ER# 0377). This report is available online at [www.iapmoes.org](http://www.iapmoes.org)



Note: Local building codes may vary; always check local building codes for details on the use of manufactured veneer products.

An inherently green product, the Landmark Collection can support LEED certification. It may absorb less heat than other wall-system cladding materials, and provides insulation that improves exterior walls' energy efficiency. It contains pre-consumer recycled content, and may earn a Regional Materials credit, depending on the project's proximity to Glen-Gery extraction and manufacturing locations.





## Interior Gallery

Exposed stone is an interior design element of stunning potential. The Landmark Collection contributes an expansive interior palette of color, texture and profile. Conveying warmth and permanence in

a residential setting, or strength and solidity in a commercial one, this product encourages creative excellence for indoor designs.



Ashford • LEDGESTONE



Buckingham • LEDGESTONE

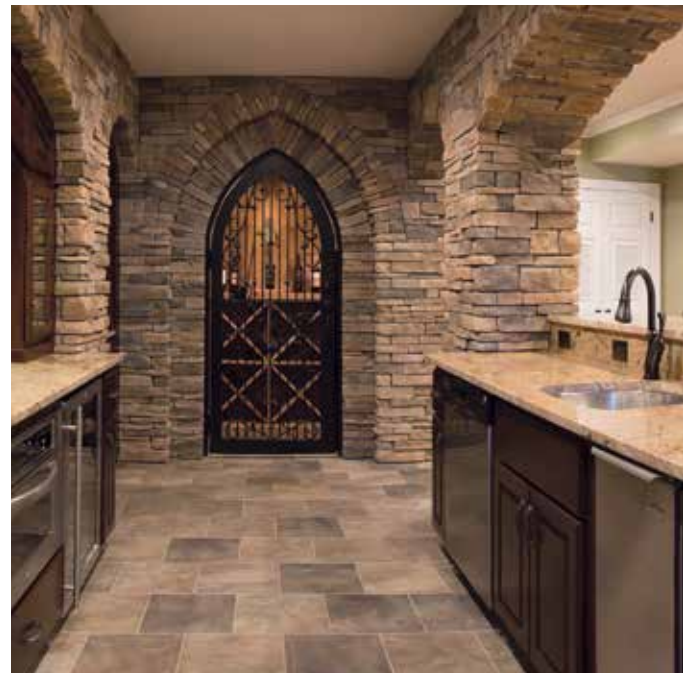

Ashford • STACKSTONE









Ashford • STACKSTONE



Buckingham • GLEN RIDGE



Kentucky Gray • LIMESTONE





San Moritz • GLEN RIDGE

## Design, details and accents

The Landmark Collection is a superb choice for interior accents, its surfaces, shapes and hues lending a remarkable versatility. With careful selection, it manifests boldness, heritage, domestic comfort and aesthetic originality, enabling seamless integration with surrounding details and materials.



Ashford • LEDGESTONE



## Stone and Brick Gallery

Design that fuses concordant materials can produce architecture of exceptional freshness and appeal. As these images demonstrate, the Landmark Collection is ideally fitted for use in combination with Glen-Gery brick. Together, these products present a generous spectrum of colors, attractive and varied shapes, and surfaces with many textural choices.

Whether the intention is to match, complement or contrast, the pairing of the Landmark Collection with our premier brick makes it possible to conceive and build striking, memorable architectural treatments that no single material can achieve.

Kentucky Gray • LIMESTONE and Ellsworth brick



Buckingham • LEDGESTONE and Battle Creek brick







**Buckingham** • FIELDSTONE and Illini Commons brick

## A perfect combination of products

For excellent results in pairing brick and manufactured stone, both materials must be produced with utmost care and craftsmanship. The quality that distinguishes Glen-Gery brick and our Landmark Collection enables architects and builders to realize the possibilities of highly sophisticated residential and commercial building plans.



**Sonoma** • GLEN RIDGE and Merlot Full-Range brick



**Buckingham** • GLEN RIDGE and Adrian brick



## AN EXPRESSION OF LASTING CHARACTER

Select from eight unique profiles in an array of available colors. Custom colors and blends are available to turn your dreams into reality. Contact our plant to learn more.



Ashford • ASHLER



Kentucky Gray • ASHLER



Allegheny • CUT COBBLE



Southern Malt • CUT COBBLE



Ashford • FIELDSTONE



Buckingham • FIELDSTONE



Canyon Creek • FIELDSTONE



San Moritz • FIELDSTONE



Sonoma • FIELDSTONE



Ashford • GLEN RIDGE



Buckingham • GLEN RIDGE



Granite • GLEN RIDGE





Portofino • GLEN RIDGE



San Moritz • GLEN RIDGE



Sonoma • GLEN RIDGE



Wheat • GLEN RIDGE



Allegheny • LEDGESTONE



Ashford • LEDGESTONE



Blue Ridge • LEDGESTONE



Buckingham • LEDGESTONE



San Moritz • LEDGESTONE



Sonoma • LEDGESTONE



Ashford • LIMESTONE



Beechnut • LIMESTONE



Buckingham • LIMESTONE



Cashmere • LIMESTONE



Chisel Gray • LIMESTONE



## Landmark Collection Profiles and Colors



Harrison • LIMESTONE



Kentucky Gray • LIMESTONE



Ashford • STACKSTONE



Beechnut • STACKSTONE



Cashmere • STACKSTONE



Chisel Gray • STACKSTONE



Deerskin • STACKSTONE



Hazelnut Creek • STACKSTONE



Prestige • STACKSTONE



Wheat • STACKSTONE



Grigio • SELECT FIT

*For color and profile availability, consult your Glen-Gery Landmark Collection representative. Due to printing limitations, color may vary from the actual stone. The number of stones displayed does not allow a complete representation of all sizes, shapes and colors for individual products.*





Kentucky Gray • LIMESTONE

## Profile measurements

### CUT COBBLE



Length: 5-1/4" to 22-1/2"  
Height: 2-1/2" to 7-5/8"  
Thickness: 1" to 2-5/8"

Rectangular

### FIELDSTONE

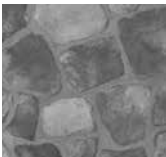

Length: 6-3/4" to 16"  
Height: 4" to 12-1/2"  
Thickness: 1" to 1-7/8"

Irregular

### SELECT FIT PANEL



Length: 10", 12" and 14"  
Height: 4"  
Thickness: 3/4" to 1-1/2"

Rectangular with moderate character between stones

### GLEN RIDGE



Length: 5-1/4" to 22-1/2"  
Height: 2-1/2" to 7-5/8"  
Thickness: 1" to 2-5/8"

Rectangular

### LEDGESTONE



Length: 5-1/2" to 22-5/8"  
Height: 1" to 4-3/8"  
Thickness: 1" to 2-1/4"

Irregular with face definitions

### LIMESTONE



Length: 6" to 19"  
Height: 2" to 11"  
Thickness: 1" to 1-5/8"

Rectangular to square, chiseled

### STACKSTONE



Length: 3-1/2" to 22"  
Height: 3/4" to 4-1/2"  
Thickness: 3/4" to 1-1/2"

Rectangular, sand face and smooth face

Select Fit Panels are designed to save time and money on the installation of your next stone veneer project. The panels are engineered for a precise fit and resemble the elegant look of a tightly laid stacked stone installation.

*NOTE: Coverage based on installation with half inch joints for all profiles except Glen Ridge, Ledgestone, Stackstone and Select Fit Panels.*



## Landmark Collection Accessories

To round out the aesthetic potential of the Landmark Collection, Glen-Gery has developed a selection of useful, attractive accessories, available in four handsome and versatile colors. These architectural details, painstakingly engineered and expertly produced, reinforce the unique presentation of any Landmark Collection project.



San Moritz • GLEN RIDGE



Granite • GLEN RIDGE with granite row lock and malt keystone

## Accents with a purpose

Glen-Gery Landmark Collection accessories are available in the following colors: granite, brown, malt and buff.

GRANITE



BROWN



MALT



BUFF



HEARTHSTONE

19-1/2" x 19-1/4" x 1-3/4"



KEystone

4" x 7-1/2" x 9" x 1-3/4"



LIGHT BOX

8-1/4" x 10-5/16" x 1-1/2"



PIER CAP

22" x 22" x 3-1/2"



RECEPTACLE BOX

6-1/4" x 7-7/8" x 1-1/2"



ROW LOCK

4" x 5" x 1-1/2"



SILL

23-1/2" x 3" x 2-1/2"



TRIMSTONE

5-1/2" x 7" x 1-1/2"



WALL CAP

14" x 20" x 3-1/2"





## Drainage technology accessories

### GLEN-GERY WEATHER-RESISTIVE BARRIER

A non-woven building wrap with a breathable polyolefin coating that performs as both a water-resistive barrier and as an air barrier in accordance with the International Building, Residential and Energy Codes.

It is an excellent secondary weather barrier that helps deflect water and wind-driven rain, yet is designed to breathe to assist trapped moisture vapor to escape, helping walls dry faster.

- UV resistant up to 9 months
- Non-woven construction
- Air barrier
- Water-resistive barrier
- Residential and commercial applications
- Allows moisture vapor to escape

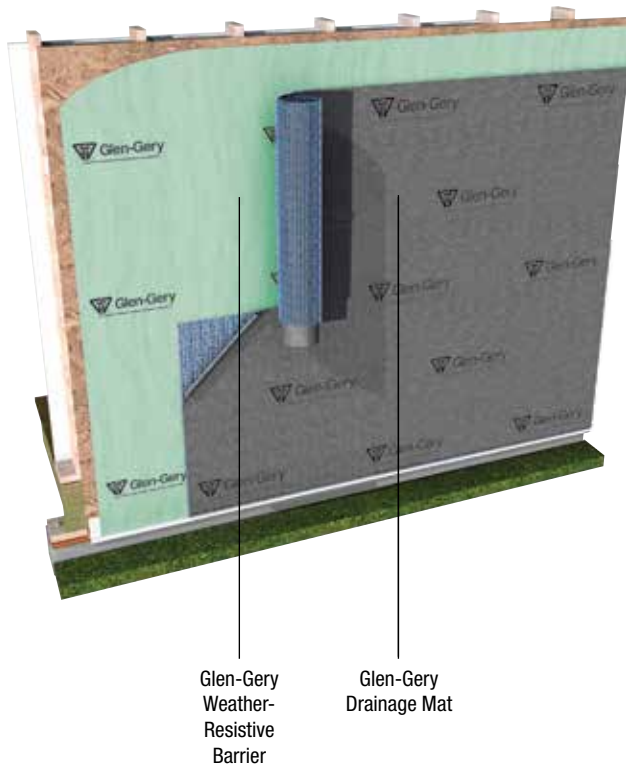

Perfect for all exterior siding applications. Our innovative rain screen technology equalizes the air pressure within the wall system by creating a drainage and ventilation cavity between the weather resistant barrier and the exterior wall.



### GLEN-GERY DRAINAGE MAT

The innovative rain screen technology equalizes the air pressure within the wall system by creating a drainage and ventilation cavity between the weather-resistant barrier and the exterior wall. This design allows excess moisture to drain from the wall system which allows air to circulate and dry the wall quickly.

- Perfect for brick and stone
- Creates a dedicated airspace behind veneer for enhanced drainage and ventilation
- Helps to prevent moisture problems, mold growth, and premature wall assembly deterioration
- Dries faster than conventional methods
- Integrated insect screen
- Class A Flame Spread Rating
- 30-day UV exposure (maximum)





## Landmark Collection 50-year warranty



All veneer stone products manufactured in Glen-Gery's Landmark Collection are warranted to be free from manufacturing defects for a period of fifty (50) years when used on structures conforming to local building codes and installed in accordance with the manufacturer's instructions. This warranty is limited to the original purchaser and is not transferable. Warranty coverage is limited to the replacement or repair of defective materials and does not cover any labor or other costs incurred for installation, removal or replacement of defective or replacement materials.

Back cover image:  
San Moritz • FIELDSTONE

[glengery.com](http://glengery.com)



A brand of

**BRICKWORKS**  
— BUILDING PRODUCTS —

Due to printing limitations, color and texture may vary from actual product. Final selection should always be based on an actual product sample.  
For more information, contact your Glen-Gery representative. © 2019 Glen-Gery Corporation • 1/19/TSG/10M